

HOGLER CRESCENT

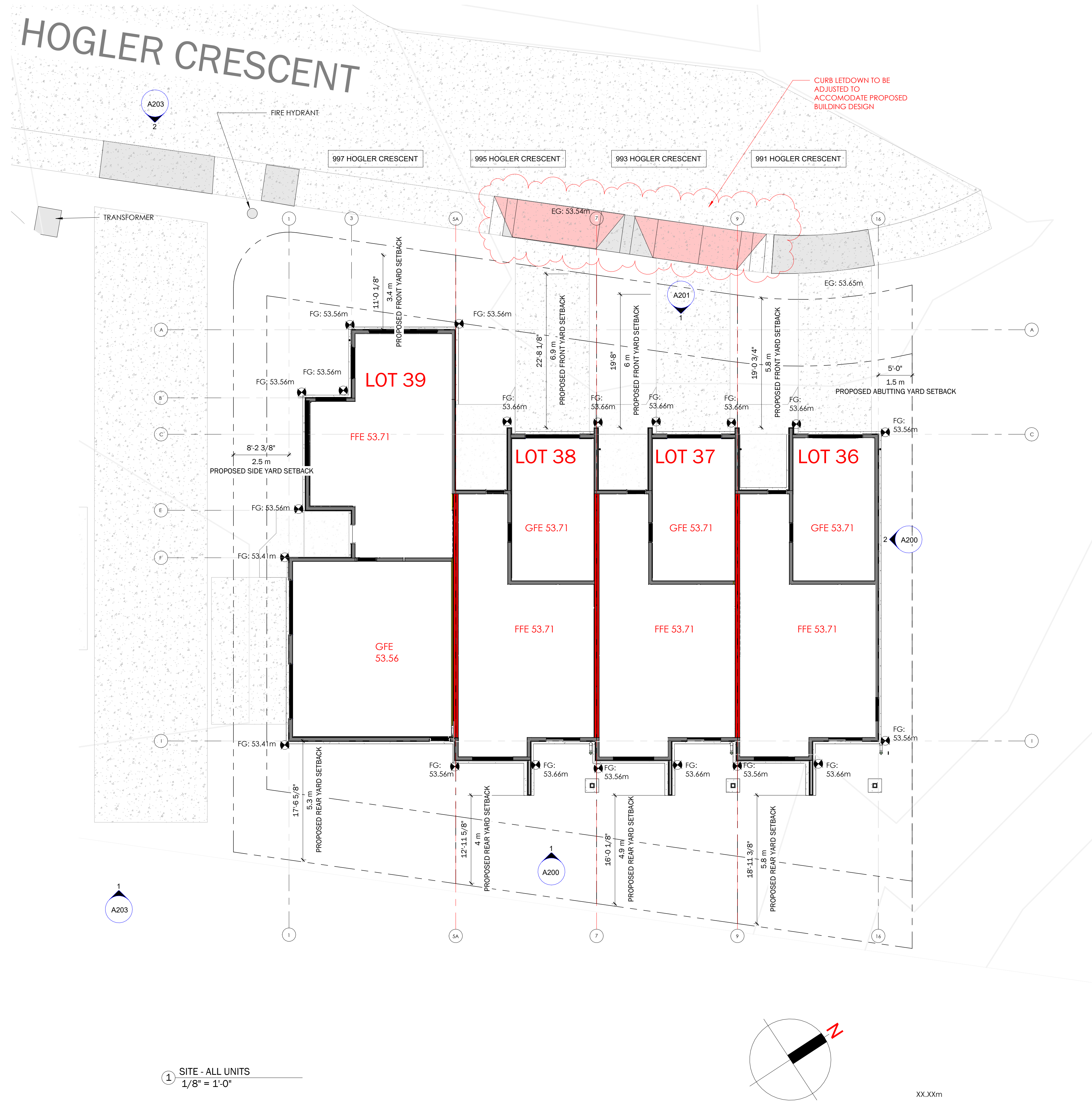

AREAS	
NAME	AREA
LOT 39 - AREA	3024 SF
LOT 38 - AREA	1929 SF
LOT 37 - AREA	1929 SF
LOT 36 - AREA	2437 SF
LOT 39 - COVERAGE	1294 SF
LOT 38 - COVERAGE	945 SF
LOT 37 - COVERAGE	900 SF
LOT 36 - COVERAGE	915 SF

GROSS FLOOR AREAS (NO GARAGE)	
LOT 39 - LEVEL 2	832 SF
LOT 38 - LEVEL 2	742 SF
LOT 37 - LEVEL 2	742 SF
LOT 36 - LEVEL 2	742 SF
LOT 39 - LEVEL 1	572 SF
LOT 38 - LEVEL 1	572 SF
LOT 37 - LEVEL 1	572 SF
LOT 36 - LEVEL 1	572 SF

1 SITE - ALL UNITS
1/8" = 1'-0"

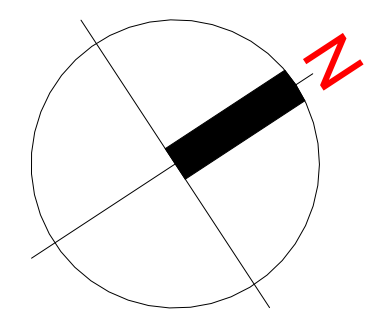

XX.XXm
DENOTES FINISHED GRADE

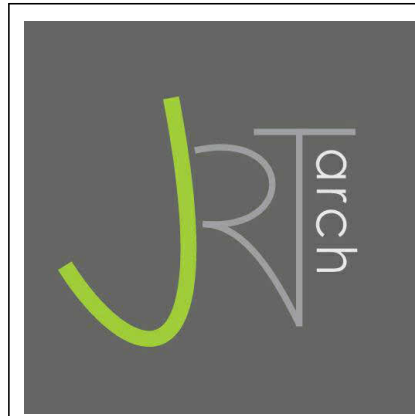

JOYCE REID TROOST ARCHITECTURE
2515 GLENAYR DRIVE
NANAIMO, BC V9S 3R9
joyce@jrtarchitecture.com
250.714.8749
jrtarchitecture.com

THE DRAWINGS, DESIGN IDEAS AND FEATURES OF CONTRIBUTION DEPICTED HEREIN ARE THE EXCLUSIVE PROPERTY OF JOYCE REID TROOST ARCHITECT. ALL COMMON COPY AND PROPERTY RIGHTS ARE EXPRESSLY RESERVED. THEY ARE NOT TO BE REPRODUCED, COPIED, REPRODUCED OR USED FOR ANY PURPOSES NOR ARE THEY TO BE ASSIGNED TO A THIRD PARTY WITHOUT EXPRESS WRITTEN CONSENT. IN THE EVENT OF ANY UNAUTHORIZED USE OF THESE PLANS BY A THIRD PARTY, THE THIRD PARTY SHALL NOT HOLD JOYCE REID TROOST ARCHITECT RESPONSIBLE.

ARCH. STAMP
RECEIVED
DP 1352
2024-SEP-19

TOWNHOMES
991, 993, 995 & 997 Hogler Crescent
NANAIMO, BC

CLIENT
HOGLER ENTERPRISES

REV. DATE	NUMBER	DESCRIPTION
21.05.24	1	ISSUED FOR DP
02.08.25	2	RE-ISSUED FOR DP

DATE: JUNE 15, 2022
SCALE: 1/8" = 1'-0"
DRAWN: CC CHECKED: JRT APPROVED: JRT

SITE PLAN - BLDG. A
A100